

ISAF SAILING WORLD CUP
ABU DHABI 28 Oct – 1 Nov, 2015



2016 ISAF Sailing World Cup

ISAF Sailing World Cup Abu Dhabi Round SAILING INSTRUCTIONS (RSI) Addendum

RSI 2 ADVERTISING and BOW NUMBERS [DP] [NP]

RSI 2.1 Boats are required to display the event sticker that will be provided by the OA and shall be fixed at the bow of the boat.

RSI 7 SAFETY REGULATIONS [DP] [NP]

RSI 7.1 Emergency Communications

Emergency services phoneline	999
Organising Authority phoneline	+971 50 321 2644

RSI 9 COMMUNICATIONS WITH COMPETITORS

RSI 9.1 In addition to <http://www.sailing.org/worldcup/onb.php>, notices to competitors will also be posted on the official notice board located in front of the launching ramp.

RSI 9.2 Signals ashore will be displayed at the flag pole located close to the race office.

RSI 9.3 There will be a daily morning meeting with team leaders at 0945 in the Home of Sailing.

RSI 9.4 When flag AP is displayed ashore, '1 minute' in RRS Race Signals AP is replaced with the time shown below:

Course Area	Time
Area Delta	30 minutes
Rest of the Areas	60 minutes

RSI 13 COURSE AREAS and MARKS

RSI13.1 Course Areas are shown in Addendum RSI 1.

RSI 13.2 Marks 1, 2, 3, and 4, or associated gate marks, will be as follows:

Race Committee Identification	Marks 1, 2, 3, 4	Offset or Windward Gate	New Mark
Race Committee A	Yellow Cylinder	Yellow Cylinder	Red Cylinder
Race Committee B	Orange Cylinder	Orange Cylinder	Red Tetrahedron
Race Committee C	Orange Cylinder	Orange Pyramid	Red Tetrahedron
Race Committee D	Orange Tetrahedron	Orange Tetrahedron	Red Cylinder

RSI 13.4 The starting and finishing line marks will be race committee vessels or inflatable marks.



ISAF SAILING WORLD CUP

ABU DHABI 28 Oct – 1 Nov, 2015



RSI 13.5 Inflatable starting and finishing line marks, when used, will be orange spheres with an orange flag.

RSI 19 PROTESTS, PENALTIES and REQUESTS for REDRESS

RSI 19.1 The protest time limit is either the number of minutes after the last boat has finished the last race of the day or “AP over A” or “N over A” is displayed for an event/fleet as shown below:

Course Area	Protest Time Limit
Area Delta	60 minutes
Rest of the Areas	90 minutes

ISAF SAILING WORLD CUP

ABU DHABI 28 Oct – 1 Nov, 2015



RSI ADDENDUM 1 CHART OF COURSE AREAS



Area	Area Centre	Area Diameter	VHF Channel
Alpha	24° 31, 415' N 054° 18,800 E	1.00 nm	
Bravo	24° 30,100 N 054° 18,740 E	1.00 nm	
Charlie	24° 30,090 N 054° 17,180 E	1.00 nm	
Delta	24° 28,640 N 054° 20,260 E	0.50 nm	

ISAF SAILING WORLD CUP

ABU DHABI 28 Oct - 1 Nov, 2015



RSI ADDENDUM 2 VENUE MAP

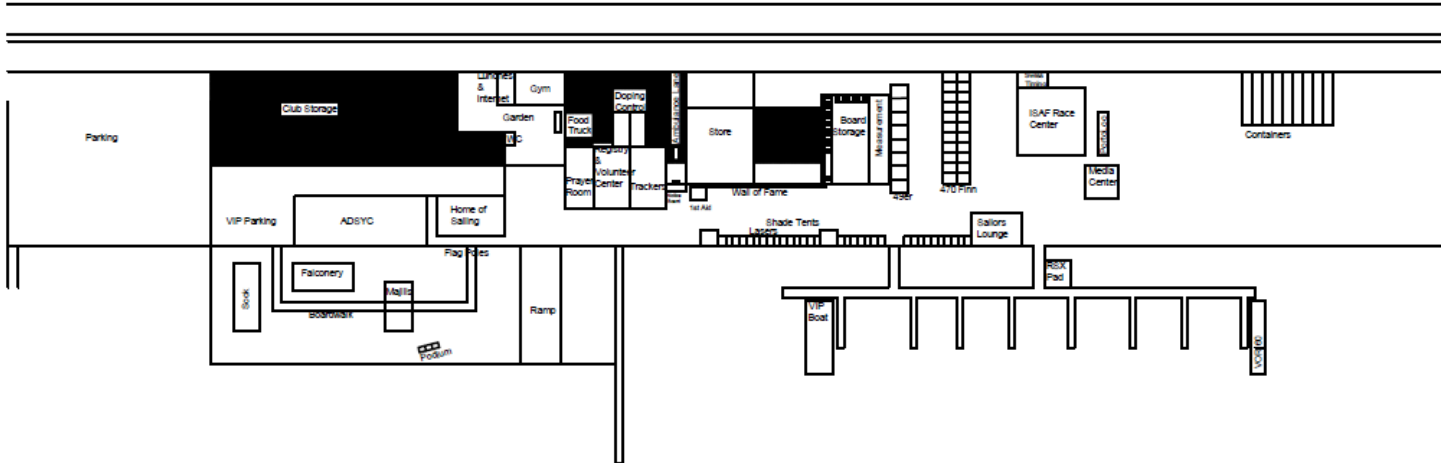

ISAF SAILING WORLD CUP

ABU DHABI 28 Oct – 1 Nov, 2015



RSI ADDENDUM 3 SCHEDULE OF RACES AND COURSE AREA ASSIGNMENT

Event Class		Thu 29 Oct	Fri 30 Oct	Sat 31 Oct	Sun 1 Nov
Men's Windsurfer	1 st Warning	12:00	14:00	12:00	TBC
RS:X Men	Course Area – No of Races	Bravo – 3	Bravo – 3	Bravo – 3	TBC – 1
Women's Windsurfer	1 st Warning	14:00	12:00	14:00	TBC
RS:X Women	Course Area – No of Races	Bravo – 3	Bravo – 3	Bravo – 3	TBC – 1
Men's One Person Dinghy	1 st Warning	12:00	12:00	12:00	TBC
Laser	Course Area – No of Races	Alpha – 2	Alpha – 2	Alpha – 2	TBC – 1
Women's One Person Dinghy	1 st Warning	12:10	12:10	12:10	TBC
Laser Radial	Course Area – No of Races	Alpha – 2	Alpha – 2	Alpha – 2	TBC – 1
Men's one Person Dinghy Heavy	1 st Warning	14:00	12:00	14:00	TBC
Finn	Course Area – No of Races	Charlie – 2	Charlie – 2	Charlie – 2	TBC – 1
Men's Skiff	1 st Warning	12:00	14:00	12:00	TBC
49er	Course Area – No of Races	Delta – 3	Delta – 3	Delta – 3	TBC – 1
Men's Two Person Dinghy	1 st Warning	12:00	14:00	12:00	TBC
470 men	Course Area – No of Races	Charlie – 2	Charlie – 2	Charlie – 2	TBC – 1
Women's Two Person Dinghy	1 st Warning	12:10	14:10	12:10	TBC
470 Women	Course Area – No of Races	Charlie – 2	Charlie – 2	Charlie – 2	TBC – 1
Formula Kite Open	1 st Warning	14:00	12:00	14:00	TBC
	Course Area – No of Races	Delta – 6	Delta – RR	Delta – RR	TBC – SF/F

